



# COUNTY OF RIVERSIDE DEPARTMENT OF ENVIRONMENTAL HEALTH

(888)722-4234 • RIVCOEH.ORG

## FOOD ESTABLISHMENT INSPECTION REPORT

FACILITY NAME <b>Speedway #3054</b>		DATE <b>07/16/2024</b>	TIME IN <b>02:45 PM</b>	TIME OUT <b>03:30 PM</b>
FACILITY ADDRESS <b>111 N Lincoln Ave Corona, CA 92882-1849</b>		FACILITY PHONE # <b>(951) 734-8853</b>		
PERMIT HOLDER <b>Western Refining Retail LLC</b>		EMAIL <b>0003054@stores.speedway.com</b>		
PERMIT # <b>PR0069100</b>	FACILITY DESCRIPTION <b>Food Market 2001 to 5999 sq ft</b>	EXPIRATION DATE <b>04/30/2025</b>	SPECIALIST NAME <b>Arturo Guerrero</b>	DISTRICT <b>54</b>
		SERVICE <b>Routine Inspection</b>	REINSPECTION DATE <b>Next Routine</b>	

THE CONDITIONS LISTED BELOW CORRESPOND TO VIOLATIONS OF THE CALIFORNIA HEALTH AND SAFETY CODE AND / OR RIVERSIDE COUNTY ORDINANCES AND ALL VIOLATIONS SHALL BE CORRECTED AS INDICATED BY THE ENFORCEMENT OFFICER. REINSPECTION / RETURN-TO-COMPLIANCE WILL BE COMPLETED/VERIFIED ON OR AFTER THE DATE INDICATED ON THIS REPORT. THE DEPARTMENT OF ENVIRONMENTAL HEALTH APPRECIATES YOUR COOPERATION.

**MAJOR / MINOR VIOLATIONS:** MAJOR VIOLATIONS ARE THOSE THAT POSE AN IMMEDIATE RISK TO PUBLIC HEALTH AND WARRANT IMMEDIATE CLOSURE OF THE FOOD FACILITY OR IMMEDIATE CORRECTION. MINOR VIOLATIONS ARE THOSE VIOLATIONS THAT DO NOT POSE AN IMMEDIATE PUBLIC HEALTH RISK, BUT DO WARRANT CORRECTION.



GRADE REPRESENTS THE FOLLOWING RANGES: A = 100-90 PASSED INSPECTION / MEETS MINIMUM HEALTH STANDARDS. B = 89-80 DID NOT PASS INSPECTION / DOES NOT MEET MINIMUM HEALTH STANDARDS. C = 79-0 FAILED INSPECTION / CONDITIONS EXIST WHICH MAY POSE A POTENTIAL OR ACTUAL THREAT TO PUBLIC HEALTH AND SAFETY. THE FACILITY IS REQUIRED TO DISPLAY A GRADE CARD IN A CONSPICUOUS PLACE SELECTED BY THE ENFORCEMENT OFFICER. THE GRADE CARD SHALL NOT BE CONCEALED AND CAN ONLY BE REMOVED OR RELOCATED BY THE ENFORCEMENT OFFICER PER COUNTY ORDINANCE 492 / COUNTY CODE SECTION 8.40.020

**SCORE 95**

In = In compliance      N/O = Not observed      N/A = Not applicable      COS = Corrected on-site      MAJ = Major Violation      OUT = Out of compliance

DEMONSTRATION OF KNOWLEDGE			COS	MAJ	OUT	FOOD FROM APPROVED SOURCES			COS	MAJ	OUT
In	N/A	1. Food safety certification Madeline Rios / 7U			2	In		15. Food obtained from approved sources		4	2
			EXP:01/07/2029			In	N/O	N/A			2
						In	N/O	N/A			2
EMPLOYEE HEALTH AND HYGIENIC PRACTICES						CONFORMANCE WITH APPROVED PROCEDURES					
In		2. Communicable disease; reporting, restrictions, and exclusions		4		In		N/A			2
In	N/O	3. No persistent discharge from eyes, nose, and mouth			2	CONSUMER ADVISORY					
In	N/O	4. Proper eating, tasting, drinking, or tobacco use			2	In		N/A			1
PREVENTING CONTAMINATION BY HANDS						SCHOOL AND HEALTHCARE PROHIBITED FOOD					
In	N/O	5. Hands clean and properly washed; gloves used properly		4	2	In		N/A		4	2
In		6. Adequate handwashing facilities supplied and accessible			2	WATER / HOT WATER					
TIME AND TEMPERATURE RELATIONSHIP						In				4	2
In	N/O	N/A		4	2	WATER TEMPERATURE: 120F					
In	N/O	N/A		4	2	LIQUID WASTE DISPOSAL					
In	N/O	N/A		4		In				4	2
In	N/O	N/A		4	2	VERMIN					
In	N/O	N/A		4	2	In				4	2
In	N/O	N/A		4		In	N/A				1
PROTECTION FROM CONTAMINATION						SANITIZER (ppm):200 Ammonia      WAREWASH TEMP: 100F					
In	N/O	N/A			2						
In				4	2						
In	N/O	N/A		4	2						

SUPERVISION / PERSONAL CLEANLINESS		OUT	EQUIPMENT / UTENSILS / LINENS		OUT	PERMANENT FOOD FACILITIES		OUT
25. Person in charge present and performs duties, demonstration of knowledge		2	34. Utensils and equipment approved, good repair		1	45. Floors, walls, ceilings: good repair / fully enclosed		1
26. Personal cleanliness and hair restraints		1	35. Warewashing: installed, maintained, proper use, test materials		1	46. Floors, walls, and ceilings: clean		1
GENERAL FOOD SAFETY REQUIREMENTS			36. Equipment / utensils: installed, clean, adequate capacity		1	47. No unapproved private homes / living or sleeping quarters		1
27. Approved thawing methods, frozen food storage		1	37. Equipment, utensils, and linens: storage and use		1	SIGNS / REQUIREMENTS		
28. Food separated and protected from contamination		2	38. Adequate ventilation and lighting; designated areas, use		1	48. Last inspection report available		
29. Washing fruits and vegetables		1	39. Thermometers provided and accurate		1	49. Food Handler Certifications available, current, and complete		1
30. Toxic substances properly identified, stored, used		1	40. Wiping cloths: properly used and stored		1	50. Grade card and signs posted, visible		
FOOD STORAGE / DISPLAY / SERVICE			PHYSICAL FACILITIES			COMPLIANCE AND ENFORCEMENT		
31. Adequate food storage; food storage containers identified		1	41. Plumbing: properly installed, good repair		1	51. Plans approved / submitted		
32. Consumer self-service		1	42. Refuse properly disposed; facilities maintained		1	52. Permit available / current		
33. Food properly labeled; honestly presented; menu labeling		1	43. Toilet facilities: properly constructed, supplied, cleaned		1	53. Permit suspended / revoked		
			44. Premises; personal item storage and cleaning item storage		1			



**COUNTY OF RIVERSIDE**  
**DEPARTMENT OF ENVIRONMENTAL HEALTH**

(888)722-4234 • RIVCOEH.ORG

**FOOD ESTABLISHMENT INSPECTION REPORT**

FACILITY NAME Speedway #3054	DATE 07/16/2024	PERMIT # PR0069100
---------------------------------	--------------------	-----------------------

**General Comments:**

This routine inspection has been conducted in conjunction with complaint investigation CO1000336.

At this time, the person in charge was unable to provide the most recent pest control invoice. Please provide a copy of your most recent pest control invoice to this department by 7/23/2024. Questions or concerns, contact [arguerrero@rivco.org](mailto:arguerrero@rivco.org)

**Observations:**

**1. Food safety certification**

**Status:** OUT ( PTS) **Type:** Violation

**Inspector Comments:** Observed the food service management certificate to be issued via 7U (7/11 university) which is not a valid, ANSI-certified certificate. Food facilities that prepare, handle or serve unpackaged potentially hazardous food, shall have an employee who has passed an approved food safety certification examination.

Provide the approved food service management certificate to this department by 8/16/2024.

**Violation Code** - Food facilities that prepare, handle or serve non-prepackaged potentially hazardous food, shall have an employee who has passed an approved food safety certification examination. Food safety certificate must be maintained at the food facility and made available for inspection. (113947.1 - 113947.5)

**21. Hot and cold water available**

**Status:** OUT ( PTS) **Type:** Violation

**Inspector Comments:** Observe water temperature at the hand washing sink at the left restroom to reach a maximum temperature of 82F. Person in charge stated that the sink requires approximately 10 minutes to reach a temperature of at least 100F. Conduct proper repairs such that the hand washing sink reaches a minimum of 100F within a reasonable amount of time.

**Violation Code** - An adequate, protected, pressurized, potable supply of hot water and cold water shall be provided at all times. Hot water of at least 120°F must be provided for facilities with unpackaged food. Handwashing facilities shall be equipped to provide warm water for at least 15 seconds. (113953(c), 114189, 114192 (a,d), 114192.1, 114195)

**34. Utensils and equipment approved, good repair**

**Status:** NOTE ( PTS) **Type:** Violation

**Inspector Comments:** Observed two torn gaskets at the customer reach in coolers. Replace torn gaskets.

Observed unused baking oven at the food prep area to be unused. Person in charge stated that the equipment is no longer necessary to the operations of the facility. Any equipment or utensils that are not necessary to the operations of the facility shall be removed.

**Violation Code** - All utensils and equipment shall be approved and in good repair. (114130, 114130.1-114130.6, 114132, 114133, 114137, 114175, 114177, 114257)

**43. Toilet facilities: properly constructed, supplied, cleaned**

**Did you know** that effective January 1, 2018, the California Health and Safety Code was amended to make it easier for food facilities to donate food? Please consider donating your excess food product to a local food bank, pantry, or soup kitchen. As a good faith food donor, you are protected from civil and criminal liability if the food product later causes harm to its recipient, unless the injury is a direct result of gross negligence or intentional misconduct in the preparation or handling of the donated food. See Section 171425 of the Civil Code and Sections 114432 to 114434 inclusive of the Health and Safety Code. For more information visit our website at [www.rivcoeh.org](http://www.rivcoeh.org).

**SIGNATURE**



PERSON IN CHARGE: Madeline Rios

PRINT



INSPECTOR: Arturo Guerrero

PRINT



**COUNTY OF RIVERSIDE  
DEPARTMENT OF ENVIRONMENTAL HEALTH**

(888)722-4234 • RIVCOEH.ORG

**FOOD ESTABLISHMENT INSPECTION REPORT**

FACILITY NAME Speedway #3054	DATE 07/16/2024	PERMIT # PR0069100
---------------------------------	--------------------	-----------------------

**Status:** NOTE ( PTS) **Type:** Violation

**Inspector Comments:** Observed right restroom to be inaccessible to the customers due to repairs being conducted to the hand washing sink. Person in charge stated that a work order has been submitted and repairs are expected to be done within a month.

**Violation Code** - Toilet facilities shall be maintained clean, sanitary, and in good repair. Toilet rooms shall be separated by a well-fitting self-closing door. Toilet tissue shall be provided in a permanently installed dispenser at each toilet. Toilet facilities shall be provided for patrons in establishments with more than 20,000 sq. ft. and in establishments offering on-site consumption. (114250, 114250.1, 114276)

**44. Premises: personal item storage and cleaning item storage**

**Status:** OUT ( PTS) **Type:** Violation

**Inspector Comments:** Observed personal belongings (motorcycle helmet, jacket, clothing) stored on the soda syrup boxes at back area. Discontinue storing personal items on food items and store in a designated area such as lockers.

Observed soiled mop head stored directly inside the mop sink. Store mop in a sanitary manner that facilitates air drying.

**Violation Code** - Lockers or another approved area for personal belongings shall be provided. The premises of each food facility shall be kept clean and free of litter and items that are unnecessary to the operation or maintenance of the facility. At least one janitorial sink with hot and cold running water shall be provided. Cleaning supplies and equipment shall be stored separate from food and food-related areas. Mops shall be store in such a way that allows air-drying. (114123, 114256, 114256.1, 114256.2, 114256.4, 114257.1, 114279, 114281, 114282)

**Did you know** that effective January 1, 2018, the California Health and Safety Code was amended to make it easier for food facilities to donate food? Please consider donating your excess food product to a local food bank, pantry, or soup kitchen. As a good faith food donor, you are protected from civil and criminal liability if the food product later causes harm to its recipient, unless the injury is a direct result of gross negligence or intentional misconduct in the preparation or handling of the donated food. See Section 171425 of the Civil Code and Sections 114432 to 114434 inclusive of the Health and Safety Code. For more information visit our website at [www.rivcoeh.org](http://www.rivcoeh.org).

**SIGNATURE**



PERSON IN CHARGE: Madeline Rios

PRINT



INSPECTOR: Arturo Guerrero

PRINT

## REASONS FOR IMMEDIATE CLOSURE OF A FOOD FACILITY

Per California Health and Safety Code Section 114409 (a):  
 "If any imminent health hazard is found, unless the hazard is immediately corrected, an enforcement officer may temporarily suspend the permit and order the food facility immediately closed."

A food facility may be closed for any of the following reasons:

- Overflowing sewage (inside or outside the facility)
- No potable water
- No hot water
- No electricity
- Rodent or insect infestation
- Any other conditions at the facility that may create an imminent public health risk

In addition to the reasons above, Per California Health and Safety Code Section 114411:

"The enforcement agency may, after providing opportunity for a hearing, modify, suspend, or revoke a permit for serious or repeated violations of any requirement of this part or for interference in the performance of the duty of the enforcement officer."

### PROPER FOOD STORAGE IN REFRIGERATORS AND FREEZERS

No foil or cardboard on shelves!

Ready-to-Eat Food

Cooked Food

Raw Meat, Raw Eggs

Store cooked and ready-to-eat food above raw food to avoid cross-contamination.  
 Keep all food covered to prevent contamination

## MANUAL SANITIZING OF EQUIPMENT AND UTENSILS USING A THREE COMPARTMENT SINK

1. **SCRAPE**, clean, or soak items as necessary before washing.
2. **WASH** items in detergent and hot water of at least 100°F in the first sink.
3. **RINSE** items in clear water in the second sink.
4. **SANITIZE** by submerging each item in a sanitizing solution in the third sink. Use one of the following sanitizing methods:
  - 100ppm of a chlorine based sanitizer for a minimum of 30 seconds in the solution
  - 200ppm of a quaternary ammonium based sanitizer for a minimum of 60 seconds in the solution
  - 25ppm of an iodine based sanitizer for a minimum of 60 seconds in the solution
  - Water at a temperature of 171°F for a minimum of 30 seconds in solution
5. **AIR DRY** all items on the drain board.

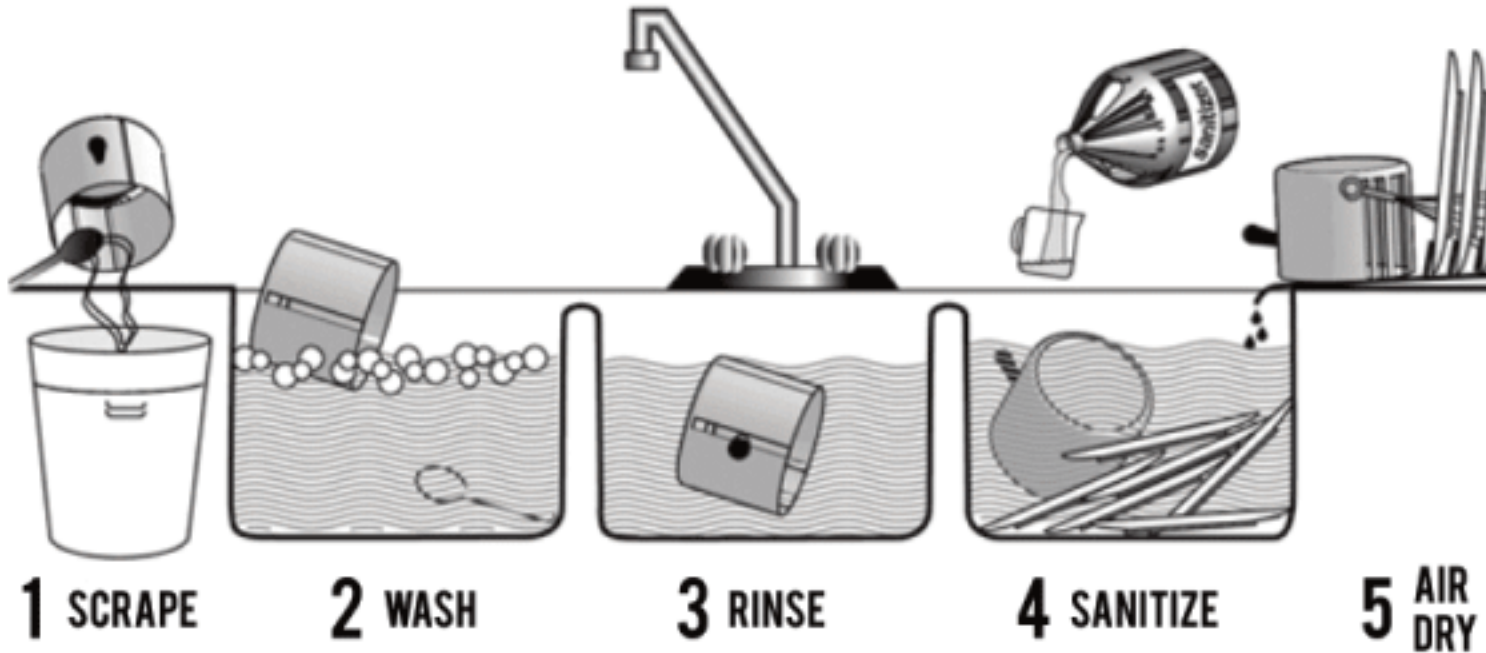

## PROPER COOLING OF FOOD IN YOUR FACILITY

Potentially hazardous foods should always be rapidly cooled.

### TIME IS THE KEY FACTOR IN PROPER COOLING

- Foods must cool from 135°F to 70°F in 2 hours or less
- Foods must cool from 70°F to 41°F in 4 hours or less

Use one of the following methods to cool food properly:

- Break large foods down into smaller portions and place in shallow pans no more than 4 inches deep. Metal pans cool better than glass or plastic pans.
- Add ice as an ingredient to replace water used in the recipe.
- Place foods within an ice bath and frequently stir the foods to speed the cooling process.
- Loosely cover foods so that heat and steam can escape during cooling.
- Arrange containers within a refrigeration unit so that air can flow properly around containers.
- Use special equipment like chill paddles or blast chillers to rapidly bring down food temperature.

Use an accurate thermometer to verify the food is being cooled within proper timeframes.

## PROPER FOOD THAWING METHODS

1. Under refrigeration
2. In a microwave oven on "defrost"
3. Submerged under cold running water in an approved preparation sink for no longer than 2 hours
4. As part of the cooking process

## INTERNAL COOKING TEMPERATURES

Use a probe thermometer to take internal cooking temperatures

<b>135°F</b> for 15 seconds	<b>145°F</b> for 15 seconds	<b>145°F</b> for 15 seconds	<b>145°F</b> for 15 seconds	<b>155°F</b> for 15 seconds	<b>155°F</b> for 15 seconds	<b>165°F</b> for 15 seconds	<b>165°F</b> for 15 seconds

Food temperature cannot be felt - use your probe thermometer!

### THE MAJOR 8 FOOD ALLERGENS

MILK

EGGS

FISH

SHELLFISH

TREE NUTS

PEANUTS

SOYBEANS

WHEAT

## FOR QUESTIONS OR COMMENTS CONTACT YOUR LOCAL AREA OFFICE

**BLYTHE**  
 260 N Broadway  
 Blythe, CA 92225  
 Self-Service Kiosk  
 Only

**CORONA**  
 2275 S Main St #204  
 Corona, CA 92882  
 Phone 951-273-9140  
 Fax 951-520-8319

**HEMET**  
 800 S Sanderson Ave #200  
 Hemet, CA 92545  
 Phone 951-766-2824  
 Fax 951-766-7874

**INDIO**  
 47-950 Arabia St #A  
 Indio, CA 92201  
 Phone 760-863-8287  
 Fax 760-863-8303

**MURRIETA**  
 30135 Technology Dr #250  
 Murrieta, CA 92563  
 Phone 951-461-0284  
 Fax 951-461-0245

**PALM SPRINGS**  
 554 S Paseo Dorotea  
 Palm Springs, CA 92264  
 Phone 760-320-1048  
 Fax 760-320-1470

**RIVERSIDE**  
 4065 County Circle Dr #104  
 Riverside, CA 92503  
 Phone 951-358-5172  
 Fax 951-358-5017