





**COUNTY OF RIVERSIDE**  
**DEPARTMENT OF ENVIRONMENTAL HEALTH**

(888)722-4234 • RIVCOEH.ORG

**FOOD ESTABLISHMENT INSPECTION REPORT**

FACILITY NAME Chick-Fil-A	DATE 10/16/2024	PERMIT # PR0076321
------------------------------	--------------------	-----------------------

**General Comments:**

Joint inspect with R.George & C. Tovar.

**Observations:**

**34. Utensils and equipment approved, good repair**

**Status:** OUT ( PTS) **Type:** Violation

**Inspector Comments:** Observed condensation leaks in walk in freezer. Repair leaks in walk in freezer. Directed affected boxed foods under leak to be moved.

**Violation Code** - All utensils and equipment shall be approved and in good repair. (114130, 114130.1-114130.6, 114132, 114133, 114137, 114175, 114177, 114257)

**36. Equipment / utensils: installed, clean, adequate capacity**

**Status:** OUT ( PTS) **Type:** Violation

**Inspector Comments:** Observed Grease inside fryer machines 1-6 cabinets. Clean inside fryer cabinets.

Observed residue on walk in cooler fan covers. Clean walk in cooler fan covers.

Observed tong storage on cart handle sticking out . Place tongs on cart and away from incidental contact.

**Violation Code** - All utensils and equipment shall be clean and installed in an approved manner. Equipment type and quantity shall be adequate for the operation. (114115, 114130.3, 114139, 114153, 114163, 114165, 114167, 114169, 114175, 114180, 114182, 114257)

**45. Floors, walls, ceilings: good repair / fully enclosed**

**Status:** OUT ( PTS) **Type:** Violation

**Inspector Comments:** Observed gaps around conduits going into ceiling tiles. Enclose gaps in ceiling tiles.

Observed broken flex conduit in back corner of facility. Replace or repair conduit.

**Violation Code** - The floors, walls, ceilings finishes must be of an approved material, durable, smooth, nonabsorbent, and easily cleanable. Food facilities shall be fully enclosed. (114143 (d), 114257, 114266, 114268, 114271, 114272)

**Did you know** you are protected from civil and criminal liability when donating food? The Federal Good Samaritan Food Donation Act (Civil Code, 171425) provides liability protections for good faith donations of surplus food. The California Good Samaritan Food Donation Act (California Retail Food Code, 114432) further expands the list of entities covered by the protection. It also allows for direct donation to a person from regulated and inspected facilities in addition to stating past-date food is subject to liability protection. Please consider donating your excess food product to a local food recovery organization. For more information visit our website at [www.rivcoeh.org](http://www.rivcoeh.org).

**SIGNATURE**

PERSON IN CHARGE: Juana Orona

PRINT

SPECIALIST: Randell George

PRINT

## REASONS FOR IMMEDIATE CLOSURE OF A FOOD FACILITY

Per California Health and Safety Code Section 114409 (a):  
 "If any imminent health hazard is found, unless the hazard is immediately corrected, an enforcement officer may temporarily suspend the permit and order the food facility immediately closed."

A food facility may be closed for any of the following reasons:

- Overflowing sewage (inside or outside the facility)
- No potable water
- No hot water
- No electricity
- Rodent or insect infestation
- Any other conditions at the facility that may create an imminent public health risk

In addition to the reasons above, Per California Health and Safety Code Section 114411:

"The enforcement agency may, after providing opportunity for a hearing, modify, suspend, or revoke a permit for serious or repeated violations of any requirement of this part or for interference in the performance of the duty of the enforcement officer."

### PROPER FOOD STORAGE IN REFRIGERATORS AND FREEZERS

Store cooked and ready-to-eat food above raw food to avoid cross-contamination.  
 Keep all food covered to prevent contamination

## MANUAL SANITIZING OF EQUIPMENT AND UTENSILS USING A THREE COMPARTMENT SINK

1. **SCRAPE**, clean, or soak items as necessary before washing.
2. **WASH** items in detergent and hot water of at least 100°F in the first sink.
3. **RINSE** items in clear water in the second sink.
4. **SANITIZE** by submerging each item in a sanitizing solution in the third sink. Use one of the following sanitizing methods:
  - 100ppm of a chlorine based sanitizer for a minimum of 30 seconds in the solution
  - 200ppm of a quaternary ammonium based sanitizer for a minimum of 60 seconds in the solution
  - 25ppm of an iodine based sanitizer for a minimum of 60 seconds in the solution
  - Water at a temperature of 171°F for a minimum of 30 seconds in solution
5. **AIR DRY** all items on the drain board.

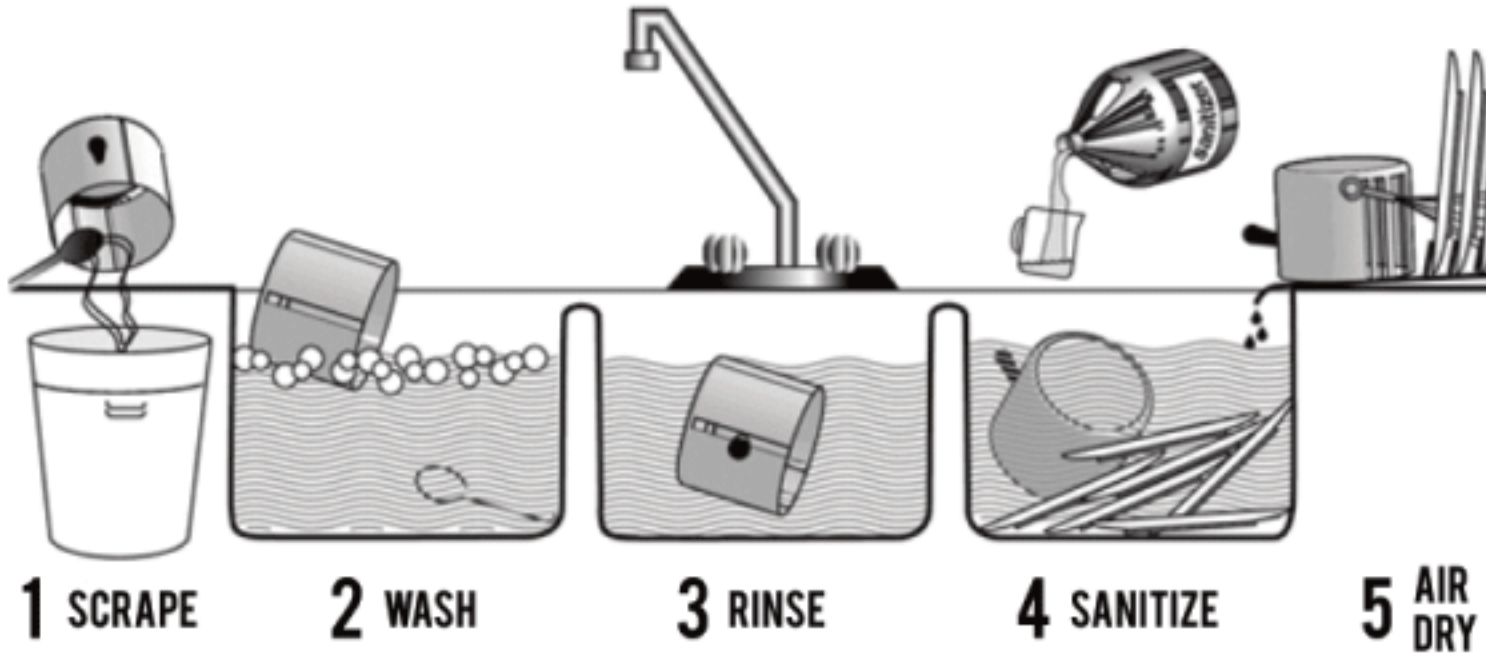

## PROPER COOLING OF FOOD IN YOUR FACILITY

Potentially hazardous foods should always be rapidly cooled.

### TIME IS THE KEY FACTOR IN PROPER COOLING

- Foods must cool from 135°F to 70°F in 2 hours or less
- Foods must cool from 70°F to 41°F in 4 hours or less

Use one of the following methods to cool food properly:

- Break large foods down into smaller portions and place in shallow pans no more than 4 inches deep. Metal pans cool better than glass or plastic pans.
- Add ice as an ingredient to replace water used in the recipe.
- Place foods within an ice bath and frequently stir the foods to speed the cooling process.
- Loosely cover foods so that heat and steam can escape during cooling.
- Arrange containers within a refrigeration unit so that air can flow properly around containers.
- Use special equipment like chill paddles or blast chillers to rapidly bring down food temperature.

Use an accurate thermometer to verify the food is being cooled within proper timeframes.

## PROPER FOOD THAWING METHODS

1. Under refrigeration
2. In a microwave oven on "defrost"
3. Submerged under cold running water in an approved preparation sink for no longer than 2 hours
4. As part of the cooking process

## INTERNAL COOKING TEMPERATURES

Use a probe thermometer to take internal cooking temperatures

<b>135°F</b> for 15 seconds	<b>145°F</b> for 15 seconds	<b>145°F</b> for 15 seconds	<b>145°F</b> for 15 seconds	<b>155°F</b> for 15 seconds	<b>155°F</b> for 15 seconds	<b>165°F</b> for 15 seconds	<b>165°F</b> for 15 seconds

Food temperature cannot be felt - use your probe thermometer!

### THE MAJOR 8 FOOD ALLERGENS

- MILK
- EGGS
- FISH
- SHELLFISH
- TREE NUTS
- PEANUTS
- SOYBEANS
- WHEAT

## FOR QUESTIONS OR COMMENTS CONTACT YOUR LOCAL AREA OFFICE

**BLYTHE**  
 260 N Broadway  
 Blythe, CA 92225  
 Self-Service Kiosk  
 Only

**CORONA**  
 2275 S Main St #204  
 Corona, CA 92882  
 Phone 951-273-9140  
 Fax 951-520-8319

**HEMET**  
 800 S Sanderson Ave #200  
 Hemet, CA 92545  
 Phone 951-766-2824  
 Fax 951-766-7874

**INDIO**  
 47-950 Arabia St #A  
 Indio, CA 92201  
 Phone 760-863-8287  
 Fax 760-863-8303

**MURRIETA**  
 30135 Technology Dr #250  
 Murrieta, CA 92563  
 Phone 951-461-0284  
 Fax 951-461-0245

**PALM SPRINGS**  
 554 S Paseo Dorotea  
 Palm Springs, CA 92264  
 Phone 760-320-1048  
 Fax 760-320-1470

**RIVERSIDE**  
 4065 County Circle Dr #104  
 Riverside, CA 92503  
 Phone 951-358-5172  
 Fax 951-358-5017