



County of Riverside
DEPARTMENT OF ENVIRONMENTAL HEALTH
 www.rivcoeh.org

FOOD ESTABLISHMENT INSPECTION FORM

FACILITY NAME Shell #68537 (6362)				DATE 2/28/2017	TIME IN 1:30 PM	TIME OUT 2:30 PM
ADDRESS 10171 Mission Blvd, Jurupa Valley, CA 92509				FACILITY DESCRIPTION Not Applicable		
PERMIT HOLDER Western Refining Retail LLC				EMAIL marketingservices@andeavor.co		Major Violations 0
PERMIT # PR0002912	EXPIRATION DATE 01/31/2022	SERVICE Routine inspection	REINSPECTION DATE 8/28/2017	FACILITY PHONE # (866)876-2455	PE 2610	DISTRICT 0056
				INSPECTOR NAME Octavio Gonzalez	Points Deducted 7	

The conditions listed below correspond to violations of the California Health and Safety Code and/or Riverside County Ordinances and must be corrected as indicated by the enforcement officer. The Department of Environmental Health appreciates your cooperation.

Failure to correct listed violation(s) prior to the designated compliance date may necessitate an additional reinspection at a charge determined by Riverside County Ordinance 640.



Major / Minor Violations: Major Violations are those that pose an imminent risk to public health and warrant immediate closure of the food facility or immediate correction. Minor Violations are those violations that do not pose an imminent public health risk, but do warrant correction.

GRADE REPRESENTS THE FOLLOWING RANGES: A = 100-90 Passed inspection / meets minimum health standards. B = 89-80 Did not pass inspection / does not meet minimum health standards. C = 79-0 Failed inspection / conditions exist which may pose a potential or actual threat to public health and safety. The facility is required to display a grade card in a conspicuous place selected by the Enforcement Officer. The grade card shall not be concealed and can only be removed or relocated by the Enforcement Officer per County Ordinance 492 / County Code Section 8.40.020

○ In = In compliance + COS = Corrected on-site ○ N/O = Not observed ○ N/A = Not applicable ○ OUT = Out of compliance

DEMONSTRATION OF KNOWLEDGE			COS	MAJ	OUT
In	N/A	1. Food safety certification			2
No open potentially hazardous foods					
EMPLOYEE HEALTH AND HYGIENIC PRACTICES					
In		2. Communicable disease; reporting, restrictions and exclusions		4	
In	N/O	3. No persistent discharge from eyes, nose, and mouth			2
In	N/O	4. Proper eating, tasting, drinking or tobacco use			2
PREVENTING CONTAMINATION BY HANDS					
In	N/O	5. Hands clean and properly washed; gloves used properly		4	2
In		6. Adequate handwashing facilities supplied and accessible			2
TIME AND TEMPERATURE RELATIONSHIPS					
In	N/O	7. Proper hot and cold holding temperatures		4	2
In	N/O	8. Time as a public health control; procedures and records		4	2
In	N/O	9. Proper cooling methods		4	2
In	N/O	10. Proper cooking time and temperature		4	2
In	N/O	11. Proper reheating procedures for hot holding		4	
PROTECTION FROM CONTAMINATION					
In	N/O	12. Returned and re-service of food			2
In		13. Food: unadulterated, no spoilage, no contamination		4	2
In	N/O	14. Food contact surfaces: clean and sanitized		4	2
quaternary ammonia available /					

FOOD FROM APPROVED SOURCES			COS	MAJ	OUT
In		15. Food obtained from approved sources		4	2
In	N/O	16. Compliance with shell stock tags, condition, display			2
In	N/O	17. Compliance with Gulf Oyster regulations			2
CONFORMANCE WITH APPROVED PROCEDURES					
In		18. Compliance with variance, specialized process, and HACCP plan			2
CONSUMER ADVISORY					
In		19. Written disclosure and reminder statements provided for raw or undercooked foods			1
SCHOOL AND HEALTHCARE PROHIBITED FOODS					
In		20. Licensed health care facilities / public and private schools; prohibited foods not offered		4	2
WATER / HOT WATER					
In		21. Hot and cold water available		4	2
Water Temperature 112 F°F					
LIQUID WASTE DISPOSAL					
In		22. Sewage and wastewater properly disposed		4	2
VERMIN					
In		23. No rodents, insects, birds, or animals		4	2
In	N/A	24. Vermin proofing, air curtains, self-closing doors			1

SUPERVISION / PERSONAL CLEANLINESS	OUT
25. Person in charge present and performs duties, demonstration of knowledge	2
26. Personal cleanliness and hair restraints	1
GENERAL FOOD SAFETY REQUIREMENTS	
27. Approved thawing methods, frozen food storage	1
28. Food separated and protected from contamination	2
29. Washing fruits and vegetables	1
30. Toxic substances properly identified, stored, used	1
FOOD STORAGE / DISPLAY / SERVICE	
31. Adequate food storage; food storage containers identified	1
32. Consumer self-service	1
33. Food properly labeled; honestly presented; menu labeling	1

EQUIPMENT / UTENSILS / LINENS	OUT
34. Utensils and equipment approved, good repair	1
35. Warewashing: installed, maintained, proper use, test materials	1
36. Equipment / utensils: installed, clean, adequate capacity	1
37. Equipment, utensils, and linens: storage and use	1
38. Adequate ventilation and lighting; designated areas, use	1
39. Thermometers provided and accurate	1
40. Wiping cloths: properly used and stored	1
PHYSICAL FACILITIES	
41. Plumbing: properly installed, good repair	1
42. Refuse properly disposed; facilities maintained	1
43. Toilet facilities: properly constructed, supplied, cleaned	1
44. Premises; personal item storage and cleaning item storage	1

PERMANENT FOOD FACILITIES	OUT
45. Floors, walls, ceilings: good repair / fully enclosed	1
46. Floors, walls, and ceilings: clean	1
47. No unapproved private homes / living or sleeping quarters	1
SIGNS / REQUIREMENTS	
48. Last inspection report available	
49. Food Handler certifications available, current, and complete	1
50. Grade card and signs posted, visible	
COMPLIANCE AND ENFORCEMENT	
51. Plans approved / submitted	
52. Permit available / current	
53. Permit suspended / revoked	
54. Voluntary condemnation	
55. Impound	



FOOD ESTABLISHMENT INSPECTION FORM

FACILITY NAME Shell #68537 (6362)	DATE 2/28/2017	PERMIT # PR0002912
--------------------------------------	-------------------	-----------------------

21. HOT AND COLD WATER AVAILABLE

POINTS

2

Inspector Comments: Facility hot water shall be at least at 120°F. Hot water was temped 112 F at 2 compartment sink faucet. The is a repeating violation, adjust hot water heater to meet proper temperature.

Violation Description: An adequate, protected, pressurized, potable supply of hot water and cold water shall be provided at all times. Hot water of at least 120°F must be provided for facilities with unpackaged food or packaged potentially hazardous food. Handwashing facilities shall be equipped to provide warm water for at least 15 seconds. (113953(c), 114189, 114192 (a,d), 114192.1, 114195)

33. FOOD PROPERLY LABELED & HONESTLY PRESENTED, ADEQUATE STORAGE

POINTS

1

Inspector Comments: Food shall be properly labeled and honesty presented. Provide label/sign at donut storage to display name and address of where the donuts are prepared.

Violation Description: Any food is misbranded if its labeling is false or misleading, if it is offered for sale under the name of another food, or if it is an imitation of another food for which a definition and standard of identity has been established by regulation. All food menu items shall be properly identified and honestly presented. Food establishments with 20 or more locations, conducting similar business, must provide approved menu nutritional labeling information. Infant formula cannot be sold or offered for sale after the "use by" date printed on the package. (114087, 114089, 114089.1(a, b), 114090, 114093.1, 114094, 114094.5)

41. PLUMBING: PROPERLY INSTALLED, GOOD REPAIR, WASTE WATER DISPOSAL

POINTS

0

Inspector Comments: All plumbing and plumbing fixtures shall be maintained so as to prevent any contamination, and shall be kept clean, fully operative, and in good repair. Provide 1 inch air gap between floor sink and drain lines under soda machine and near ice machine. This is to prevent contamination if sink fills with waste water.

Violation Description: All plumbing shall be installed in compliance with local plumbing ordinances, shall be maintained so as to prevent any contamination, and shall be kept clean, fully operative, and in good repair. All food-related equipment drain lines must discharge through an approved indirect connection. Any hose used for conveying potable water shall be made from approved material and used for no other purpose. (114171, 114189.1, 114190, 114192(b,c), 114193, 114193.1, 114199, 114201, 114269)

42. REFUSE PROPERLY DISPOSED: FACILITIES MAINTAINED

POINTS

1

Inspector Comments: All food waste and rubbish shall be kept in covered, leak proof and rodent proof containers. Observed trash and debris on the floor of refuse bin enclose. Relocate all waste inside bin.

Violation Description: All food waste and rubbish shall be kept in leakproof and rodent-proof containers. Containers shall be covered at all times. All waste must be removed and disposed of as frequently as necessary to prevent a nuisance. The exterior premises of each food facility shall be kept clean and free of litter and rubbish. (114244, 114245, 114245.1, 114245.2, 114245.3, 114245.4, 114245.5, 114245.6, 114245.7, 114257.1)

43. TOILET FACILITIES: PROPERLY CONSTRUCTED, SUPPLIED, CLEANED

POINTS

1

Inspector Comments: Toilet facilities shall be maintained clean, sanitary and in good repair. Replace non functioning exhaust fan inside employee restroom or repair unit.

Violation Description: Toilet facilities shall be maintained clean, sanitary, and in good repair. Toilet rooms shall be separated by a well-fitting self-closing door. Toilet tissue shall be provided in a permanently installed dispenser at each toilet. Toilet facilities shall be provided for patrons in establishments with more than 20,000 sq. ft. and in establishments offering on-site consumption. (114250, 114250.1, 114276)

45. FLOORS, WALLS, CEILING: GOOD REPAIR/FULLY ENCLOSED

POINTS

1

Inspector Comments: The floors, walls, ceilings of a food facility shall be approved type, have durable, smooth, nonabsorbent, and washable surfaces, and shall be kept clean and in good repair. Replace missing ceiling panel above 2 compartment sink to prevent rodent entry.

Violation Description: The floors, walls, ceilings finishes must be of an approved material, durable, smooth, nonabsorbent, and easily cleanable. Food facilities shall be fully enclosed. (114143 (d), 114257, 114266, 114268, 114271, 114272)

49. FOOD HANDLER CERTIFICATES AVAILABLE, CURRENT, COMPLETE

POINTS

1

Inspector Comments: All employees who handle food, utensils, or food equipment shall have a valid Riverside County food handler card. Food handler cards for employees not available. Ensure that all employees obtain card and copy of card available on site.

Violation Description: County of Riverside Environmental Health Food Handler Certification(s) are available and current for all employees who prepare, store, or serve exposed food. (Riverside County Ordinance 567)



County of Riverside
DEPARTMENT OF ENVIRONMENTAL HEALTH
www.rivcoeh.org

FOOD ESTABLISHMENT INSPECTION FORM

FACILITY NAME Shell #68537 (6362)	DATE 2/28/2017	PERMIT # PR0002912
--------------------------------------	-------------------	-----------------------

Overall Inspection Comments

No summary comments have been made for this inspection.

Signature

Tamer elmezian
Person in Charge
02/28/2017

Octavio Gonzalez
Environmental Health Specialist
02/28/2017

REASONS FOR IMMEDIATE CLOSURE OF A FOOD FACILITY

Per California Health and Safety Code Section 114409 (a):
 "If any imminent health hazard is found, unless the hazard is immediately corrected, an enforcement officer may temporarily suspend the permit and order the food facility immediately closed."

A food facility may be closed for any of the following reasons:

- Overflowing sewage (inside or outside the facility)
- No potable water
- No hot water
- No electricity
- Rodent or insect infestation
- Any other conditions at the facility that may create an imminent public health risk

In addition to the reasons above, Per California Health and Safety Code Section 114411:

"The enforcement agency may, after providing opportunity for a hearing, modify, suspend, or revoke a permit for serious or repeated violations of any requirement of this part or for interference in the performance of the duty of the enforcement officer."

PROPER FOOD STORAGE IN REFRIGERATORS AND FREEZERS

Ready-to-Eat Food

Cooked Food

Raw Meat, Raw Eggs

Store cooked and ready-to-eat food above raw food to avoid cross-contamination. Keep all food covered to prevent contamination.

MANUAL SANITIZING OF EQUIPMENT AND UTENSILS USING A THREE COMPARTMENT SINK

1. **SCRAPE**, clean, or soak items as necessary before washing.
2. **WASH** items in detergent and hot water of at least 100°F in the first sink.
3. **RINSE** items in clear water in the second sink.
4. **SANITIZE** by submerging each item in a sanitizing solution in the third sink. Use one of the following sanitizing methods:
 - 100ppm of a chlorine based sanitizer for a minimum of 30 seconds in the solution
 - 200ppm of a quaternary ammonium based sanitizer for a minimum of 60 seconds in the solution
 - 25ppm of an iodine based sanitizer for a minimum of 60 seconds in the solution
 - Water at a temperature of 171°F for a minimum of 30 seconds in solution
5. **AIR DRY** all items on the drain board.

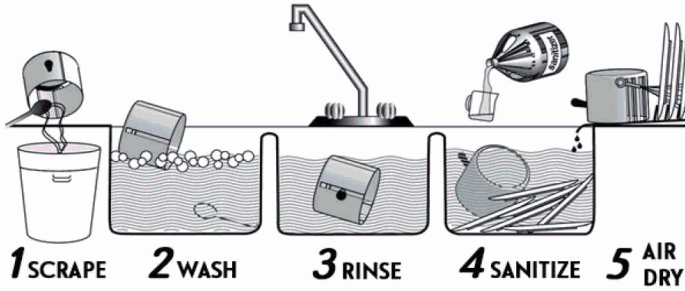

PROPER COOLING OF FOOD IN YOUR FACILITY

Potentially hazardous foods should always be rapidly cooled.

TIME IS THE KEY FACTOR IN PROPER COOLING

- Foods must cool from 135°F to 70°F in 2 hours or less
- Foods must cool from 70°F to 41°F in 4 hours or less

Use one of the following methods to cool food properly:

- Break large foods down into smaller portions and place in shallow pans no more than 4 inches deep. Metal pans cool better than glass or plastic pans.
- Add ice as an ingredient to replace water used in the recipe.
- Place foods within an ice bath and frequently stir the foods to speed the cooling process.
- Loosely cover foods so that heat and steam can escape during cooling.
- Arrange containers within a refrigeration unit so that air can flow properly around containers.
- Use special equipment like chill paddles or blast chillers to rapidly bring down food temperature.

Use an accurate thermometer to verify the food is being cooled within proper timeframes.

PROPER FOOD THAWING METHODS

1. Under refrigeration
2. In a microwave oven on "defrost"
3. Submerged under cold running water in an approved preparation sink for no longer than 2 hours
4. As part of the cooking process

INTERNAL COOKING TEMPERATURES

Use a probe thermometer to take internal cooking temperatures

135°F for 15 seconds	145°F for 15 seconds	145°F for 15 seconds	145°F for 15 seconds	155°F for 15 seconds	155°F for 15 seconds	165°F for 15 seconds	165°F for 15 seconds

Food temperature cannot be felt - use your probe thermometer!

FOOD ALLERGENS

THE MAJOR 8

FOR QUESTIONS OR COMMENTS CONTACT YOUR LOCAL AREA OFFICE

BLYTE 260 N Broadway Blythe, CA 92225 Phone 760-921-5090 Fax 760-921-5085	CORONA 2275 S Main St #204 Corona, CA 92882 Phone 951-273-9140 Fax 951-520-8319	HEMET 800 S Sanderson Ave #200 Hemet, CA 92545 Phone 951-766-2824 Fax 951-766-7874	INDIO 47-950 Arabia St #A Indio, CA 92201 Phone 760-863-8287 Fax 760-863-8303	MURRIETA 30135 Technology Dr #250 Murrieta, CA 92563 Phone 951-461-0284 Fax 951-461-0245	PALM SPRINGS 554 S Paseo Dorotea Palm Springs, CA 92264 Phone 760-320-1048 Fax 760-320-1470	RIVERSIDE 4065 County Circle Dr #104 Riverside, CA 92503 Phone 951-358-5172 Fax 951-358-5017
--	--	---	--	---	--	---